



PN150 Acc. to ISO 17292 STANDARD **800 Class**
FORGED STEEL EXTENDED BALL VALVES
 FLOATING BALL, FULL BORE, SOFT SEATED, FIRE SAFE, ASD

Figure

E604W.12



DIMENSIONS & WEIGHT of E604W

NPS	DN	ID	L	L1	H	W	Wt
inc.	mm	mm	mm	mm	mm	mm	Kg
1/2	15	12.5	80	180	65	150	1.5
3/4	20	17	95	195	72	150	2
1	25	23	115	215	80	170	3
1 1/2	40	37	135	235	105	240	6
2	50	49	155	255	114	240	12

	TEST PRESSURE	WORKING PRESSURE
SHELL	225 Bar	-29+100 °C 150 Bar
CLOSURE	150 Bar	

PART LIST for Material No.12

Item	PART NAME	Symb.	material
12	ANTISTATIC DEVICE	SS	SPRING+BALL
11	GLAND	304	ASTM A182 Gr.304
10	STEM SEALING	PTFE	Polytetrafluoroethylene
9	GASKET	GRF	GRAPHITE
8	NUT	2H	ASTM A194 Gr.2H
7	WRENCH	St	STEEL
6	PACKING	GRF	GRAPHITE
5	STEM	304	ASTM A182 Gr.304
4	BODY INSERT	A105	ASTM A105
3	BALL	304	ASTM A182 Gr 304
2	SEAT INSERT	PTFE	Polytetrafluoroethylene
1	BODY	A105	ASTM A105

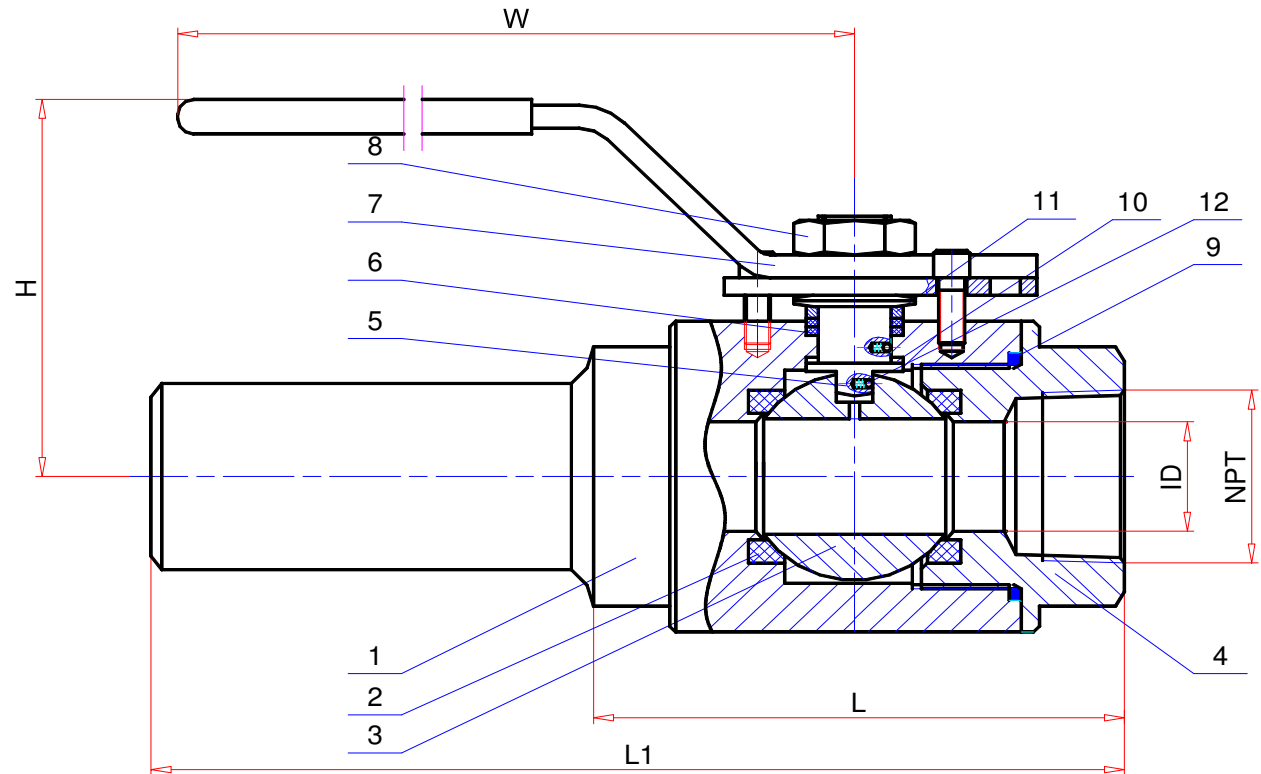

DESIGN STD.: **ASME B16.34** TEST STD.: **ISO 5208** END TYPE: **BW-NPT** (Buttweld end - Female NPT) MAT'L ID.: **A105** TRIM ID.: **304+PTFE**

Prep.K.KORKMAZ	Che.:U.ÖZDEMİR	Appr.:N.ERGIN	Rev.No / Date:R0 / 20.08.2006	Description:	Datasheet Nr.:E604W.12	Attach.	Page&Scale:1/1 A4	Origin:DES
----------------	----------------	---------------	-------------------------------	--------------	------------------------	---------	-------------------	------------