



PN50 Acc. to ISO 17292 STANDARD **300 Class**
FORGED STEEL BALL VALVES Flanged
 FLOATING BALL, SOFT SEATED, FIRE SAFE, ASD

Figure

E602F.12



DIMENSIONS & WEIGHT of E602F

NPS	DN	ØD	b	g	ØK	n	ØI	L	H	W	Wt
inc.	mm	mm	mm	mm	mm	no	mm	mm	mm	mm	Kg
1/2	15	95.5	14.5	35	66.5	4	16	139	65	150	2.5
3/4	20	117.5	16.5	43	82.5	4	19	152	72	150	4.2
1	25	124	17.5	51	89	4	19	165	80	170	6
1 1/2	40	155.5	20.5	73	114.3	4	22	190.5	105	240	11.5
2	50	165	22.5	92	127	8	19	216	114	240	17.3

	TEST PRESSURE	WORKING PRESSURE
SHELL	77 Bar	-29+100 °C
CLOSURE	56 Bar	

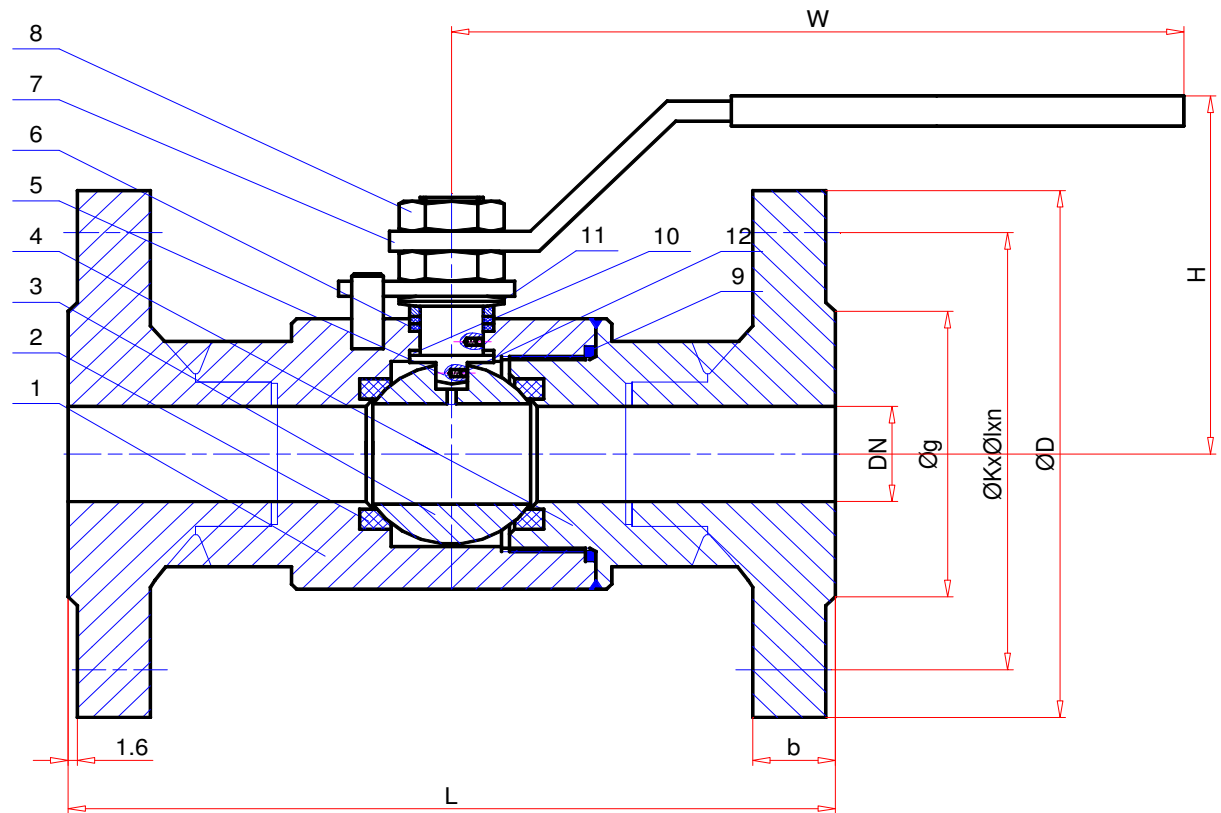

PART LIST for Material No.12

Item	PART NAME	Symb.	material
12	ANTISTATIC DEVICE	SS	SPRING+BALL
11	GLAND	304	ASTM A182 Gr.304
10	STEM SEALING	PTFE	Polytetrafluoroethylene
9	GASKET	GRF	GRAPHITE
8	NUT	2H	ASTM A194 Gr.2H
7	WRENCH	St	STEEL
6	PACKING	GRF	GRAPHITE
5	STEM	304	ASTM A182 Gr.304
4	BODY INSERT	A105	ASTM A105
3	BALL	304	ASTM A182 Gr 304
2	SEAT INSERT	PTFE	Polytetrafluoroethylene
1	BODY	A105	ASTM A105

DESIGN STD: **ASME B16.34** TEST STD.: **ISO 5208** F to F: **ASME B16.10** END TYPE: **ANSI B16.5 RF-300** MAT'L ID.: **A105** TRIM ID.: **304+PTFE**

Prep.K.KORKMAZ Che.:U.ÖZDEMİR Appr.:N.ERGIN Rev.No / Date:R1 / 20.08.2006 Description: Datasheet Nr.:E602F.12 Attach. Page&Scale:1/1 A4 Origin:DES