



**PN20** Acc. to ISO 17292 STANDARD **150 Class**  
**FORGED STEEL BALL VALVES Flanged**  
 FLOATING BALL, SOFT SEATED, FIRE SAFE, ASD

Figure

**E601F.12**



**DIMENSIONS & WEIGHT of E601F**

NPS	DN	ØD	b	g	ØK	n	ØI	*L	H	W	Wt
inc.	mm	mm	mm	mm	mm	no	mm	mm	mm	mm	Kg
1/2	15	89	9.5	35	60.4	4	16	165	65	150	2
3/4	20	98.5	10.5	43	69.8	4	16	190.5	72	150	3
1	25	108	11	51	79	4	16	216	80	170	4.8
1 1/2	40	127	14	73	98.5	4	16	241	105	240	8.7
2	50	152.5	16	92	120.7	4	19	292	114	240	15.5

	TEST PRESSURE	WORKING PRESSURE
SHELL	30 Bar	-29+100 °C
CLOSURE	22 Bar	

**PART LIST for Material No.12**

Item	PART NAME	Symb.	material
12	ANTISTATIC DEVICE	SS	SPRING+BALL
11	GLAND	304	ASTM A182 Gr.304
10	STEM SEALING	PTFE	Polytetrafluoroethylene
9	GASKET	GRF	GRAPHITE
8	NUT	2H	ASTM A194 Gr.2H
7	WRENCH	St	STEEL
6	PACKING	GRF	GRAPHITE
5	STEM	304	ASTM A182 Gr.304
4	BODY INSERT	A105	ASTM A105
3	BALL	304	ASTM A182 Gr 304
2	SEAT INSERT	PTFE	Polytetrafluoroethylene
1	BODY	A105	ASTM A105

\* : F to F (L) dimension is according to 600#

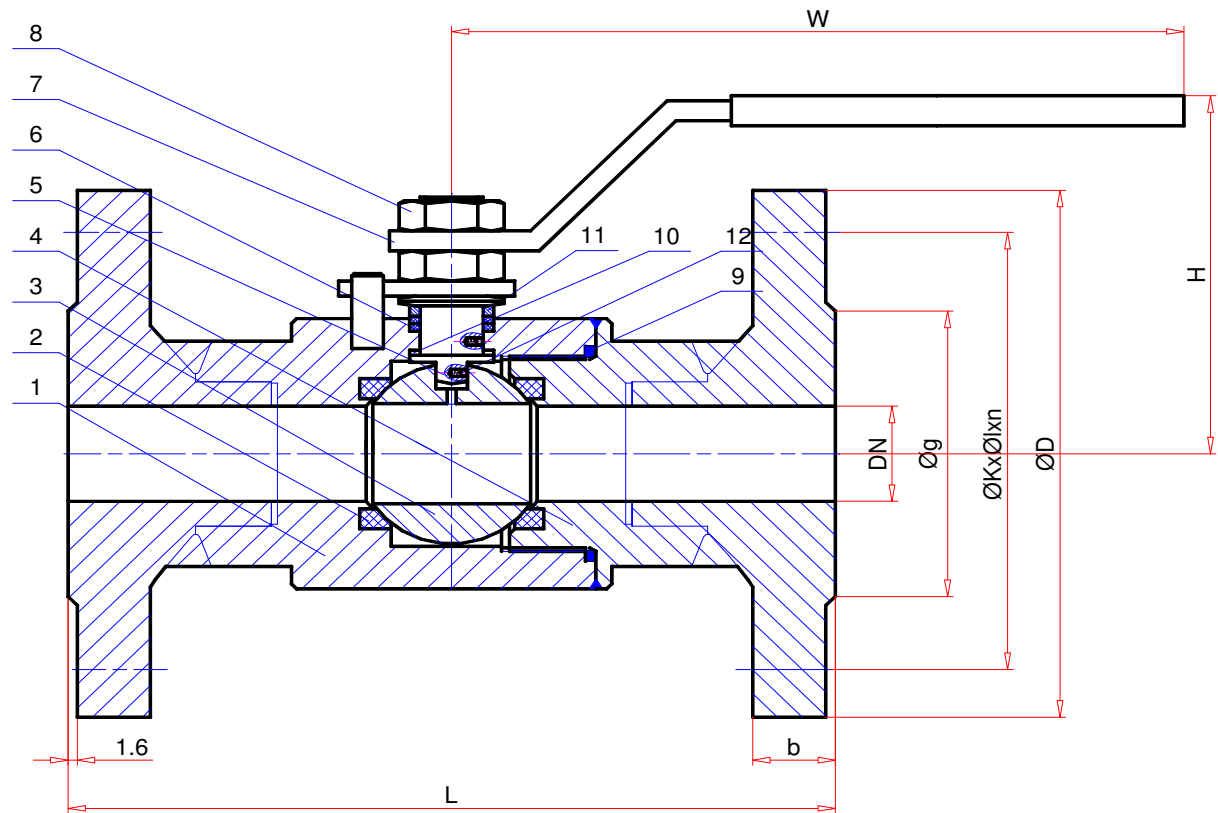

DESIGN STD: **ASME B16.34** TEST STD.: **ISO 5208** F to F: **ASME B16.10** END TYPE: **ANSI B16.5 RF-150** MAT'L ID.: **A105** TRIM ID.: **304+PTFE**

Prep.K.KORKMAZ Che.:U.ÖZDEMİR Appr.:N.ERGIN Rev.No / Date:R2 / 02.07.2007 Description: Datasheet Nr.:E601F.12 Attach. Page&Scale:1/1 A4 Origin:DES