

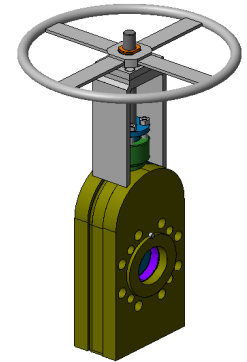

PN110 **600 Class**
Carbon Steel CONDUIT GATE VALVES
 SHORT TYPE, THREADED LUG, OUTSIDE SCREWED & YOKE, RISING STEM

Figure

E50.18



DIMENSIONS & WEIGHT of E50									
DN	ID	ØD	Øg	ØK	n	ØI	L	H	Wt
inc.	mm	mm	mm	mm	no	mm	mm	mm	kg
3"	80	210	127	152	4	3/4"-10UNC	110	460	45
4"	105	273	157	191	8	7/8"-9 UNC	140	535	90
6"	155	356	216	241	8	1"-8 UNC	150	715	205
8"	205	419	270	299	8	1 1/8"-8 UN	200	915	350
10"	255	508	324	362	12	1 1/4"-8 UN	220	1095	615
12"	305	559	381	432	12	1 1/4"-8 UN	250	1225	910

WORKING PRESSURE	
-29+100 °C	102 Bar
TEST PRESSURE	
Shell & Backseat	153 Bar
Closure	122 Bar
Air	6 Bar

PART LIST for Material No.18			
Item	PART NAME	Symb.	material
1	Body	CS	ASTM A515
1a	RF Ring	CS	ASTM A515
1b	Bolting	B	A307 B
2	Seat Ring	CS	A105
2a	Body Seat FACE	Cr13	AWS 430
2b	Soft Seat	PTFE	PolyTetraFluoroEthylene
2c	O-Ring	C	NBR
2e	Spring	SS	AISI 302
3	Gate	CS	ASTM A515
3a	GATE Seat Face	Cr13	AWS 430
4	Stem	Cr13	AISI 410
6	Packing	GRF	Graphite
8	Gland Flange	ST	STEEL
9	Gland Bolt	B	A307 B
11	Bushing	BZ	ASTM B148
12	Yoke	ST	STEEL
17	Handwheel	ST	STEEL
18	Name Plate	ST	STAINLESS PLATE
19	Paint	EP	EPOXY COATING
19a	End Cover	W	WOODEN

