



API 6D STANDARD
150 Class Cast Steel CHECK VALVES PN20
 SWING TYPE, BOLTED COVER

Figure

E410.11



6D-0449

DIMENSIONS (mm) & WEIGHT of E410											
DN	ID	ØD	b	Øg	ØK	n	ØI	L	H	Wt	KV
inch.	mm	mm	mm	mm	mm	no	mm	mm	mm	kg	
2"	51	153	16	92	121	4	19	203	210	20	230
2½"	64	178	18	105	140	4	19	216	235	23	340
3"	76	191	19	127	152	4	19	241	245	33	530
4"	102	229	24	157	191	8	19	292	260	51	720
5"	127	254	24	186	216	8	22	330	290	67	1280
6"	152	280	26	216	241	8	22	356	320	87	1790
8"	203	343	29	270	299	8	22	495	370	142	2500
10"	254	407	30	324	362	12	26	622	410	245	4800
12"	305	483	32	381	432	12	26	699	430	350	7500
14"	337	534	35	413	476	12	29	787	500	440	9800
16"	387	597	37	470	540	16	29	864	530	590	13600
18"	438	635	40	534	578	16	32	978	600	850	16200
20"	489	699	43	584	635	20	32	978	660	910	22200
24"	591	813	48	692	749	20	35	1295	730	1600	33300
28"	686	1060	57	908	978	28	41	1448	950	1950	
30"	737	1170	62	1022	1086	32	41	1524	1040	2500	
32"	781	1060	57	908	978	28	41	1524	1100	3000	
36"	876	1170	62	1022	1086	32	41	1956	1200	3800	
42"	1020	1345	67	1194	1257	36	42	--	1350	4500	
48"	1166	1510	70	1359	1422	44	42	--	1500	4850	

	TEST PRESSURE	WORKING PRESSURE
SHELL	30 Bar	-29+38 °C 20 Bar
Closure	22 Bar	+425 °C 6 Bar

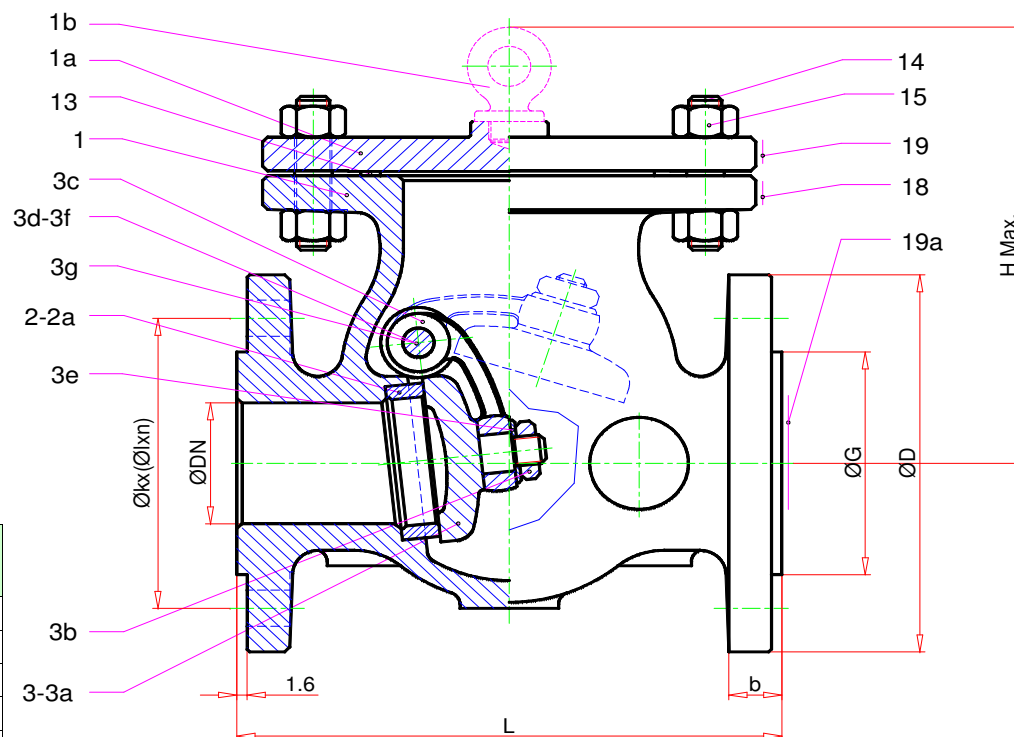

PART LIST for Material No.11							
Item	PART NAME	Symb.	material	Item	PART NAME	Symb.	material
1	BODY	WCB	ASTM A216 Gr.WCB	3e	Disc Washer	ST	STEEL
1a	BONNET	ST	ASTM A515	3f	Plug	ST	STEEL
1b	HOOK (*)	ST	ASTM A307.B	3g	Plug Seal	GRF	GRAPHITE
2	BODY SEAT RING	ST	ASTM A105	13	GASKET	NASF	Non Asbestos S.F.
2a	Body Seat FACE	Cr13	AWS ER430	14	STUD BOLT	B7	ASTM A193Gr.B7
3	DISC	ST	ASTM A515	15	NUT	2H	ASTM A194Gr.2H
3a	Disc Seat FACE	Cr13	AWS ER430	18	NAME PLATE	SP	STAINLESS PLATE
3b	Disc Nut	2H	ASTM A194Gr.2H	19	PAINT	EP	EPOXY
3c	Disc Hinge	WCB	ASTM A216 Gr.WCB	19a	END COVER	PVC	PLASTIC
3d	Disc Pin	Cr13	ASTM A276 T.410				(*) IF REQUIRED

DESIGN STD: API 6D	TEST STD: API 6D & API 598	FACE to FACE STD: ANSI B16.10	FLANGE STD: ANSI B16.5 RF	MAT'L ID :WCB	TRIM ID : Cr13-Cr13-Cr13
Prep.:T. AKYÜREK	Che.:K.KORKMAZ	Appr.:N.Ergin	Rev.No&Date: R4/ 01.04.2009	Description:	Doc No: E410.11-9R0
				Attach.	Page&Scale: 1/1 & A4
					Origin: DES



API 6D STANDARD
300 Class Cast Steel CHECK VALVES PN 50
 SWING TYPE, BOLTED COVER

Figure

E420.11



6D-0449

DIMENSIONS (mm) & WEIGHT of E420

DN	ID	ØD	b	Øg	ØK	n	ØI	L	H	Wt	Kv
inch.	mm	mm	mm	mm	mm	no	mm	mm	mm	kg	
2"	51	165	23	92	127	8	19	268	220	22	230
2½"	64	191	25	105	149	8	22	292	240	26	340
3"	76	210	29	127	168	8	22	318	260	41	530
4"	102	254	32	157	200	8	22	356	275	59	720
5"	127	280	35	186	235	8	22	400	300	-----	1280
6"	152	318	37	216	270	12	22	445	330	110	1790
8"	203	381	41	270	330	12	26	533	380	221	2500
10"	254	445	48	324	387	16	29	622	430	350	4800
12"	305	521	51	381	451	16	32	711	520	508	7500
14"	337	585	54	413	514	20	32	838	540	600	9800
16"	387	648	57	470	572	20	35	864	590	810	13600
18"	438	711	61	534	629	24	35	978	670	-----	16200
20"	489	775	64	584	686	24	35	1016	710	1480	22200
24"	591	915	70	692	813	24	41	1346	800	-----	33300

	TEST PRESSURE	WORKING PRESSURE
SHELL	77 Bar -29+38 °C	51 Bar
Closure	56 Bar +425 °C	29 Bar

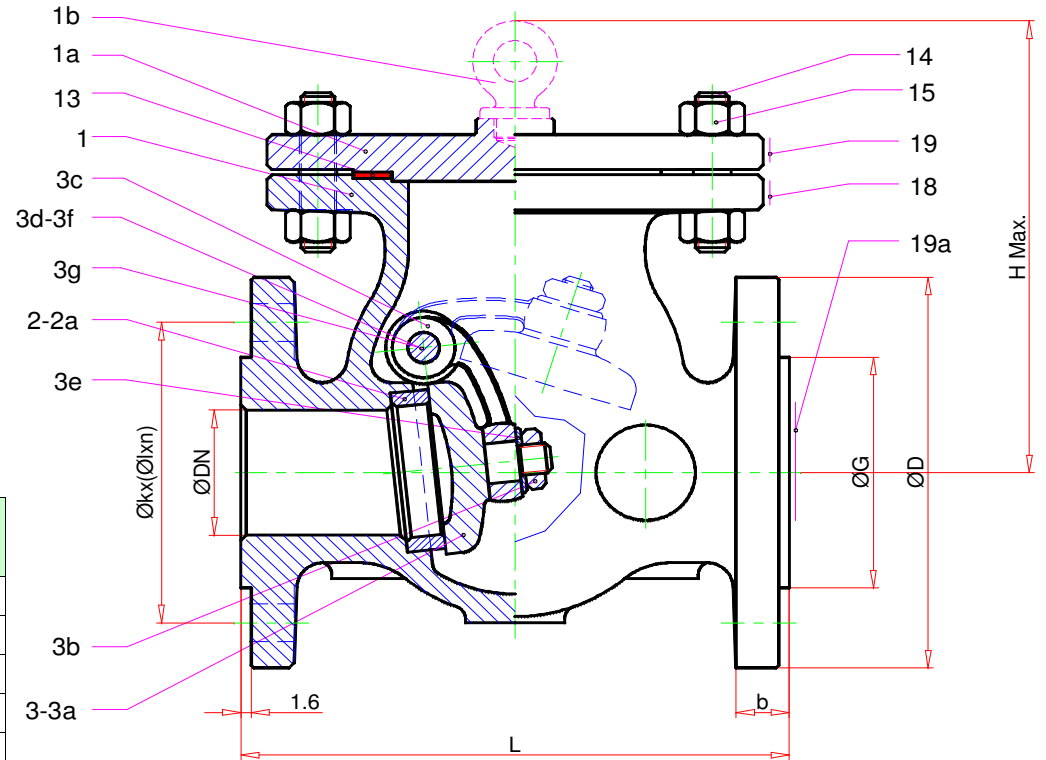

PART LIST for Material No.11

Item	PART NAME	Symb.	material	Item	PART NAME	Symb.	material
1	BODY	WCB	ASTM A216 Gr.WCB	3e	Disc Washer	ST	STEEL
1a	BONNET	ST	ASTM A515	3f	Plug	ST	STEEL
1b	HOOK (*)	ST	ASTM A307.B	3g	Plug Seal	GRF	GRAPHITE
2	BODY SEAT RING	ST	ASTM A105	13	GASKET	SWG	304-GRAPHITE
2a	Body Seat FACE	Cr13	AWS ER410	14	STUD BOLT	B7	ASTM A193Gr.B7
3	DISC	ST	ASTM A515	15	NUT	2H	ASTM A194Gr.2H
3a	Disc Seat FACE	Cr13	AWS ER410	18	NAME PLATE	SP	STAINLESS PLATE
3b	Disc Nut	2H	ASTM A194Gr.2H	19	PAINT	EP	EPOXY
3c	Disc Hinge	WCB	ASTM A216 Gr WCB	19a	END COVER	PVC	PLASTIC
3d	Disc Pin	Cr13	ASTM A276 T.410				

(*) IF REQUIRED

DESIGN STD: API 6D TEST STD: API 6D & API 598 FACE to FACE STD: ANSI B16.10 FLANGE STD: ANSI B16.5 RF MAT'L ID :WCB TRIM ID : Cr13-Cr13-Cr13

Prep.:T. AKYÜREK	Che.:K.KORKMAZ	Appr.:N.Ergin	Rev.No&Date: R5/ 01.04.2009	Description:	Doc No: E420.11-9R0	Attach.	Page&Scale: 1/1 & A4	Origin:	DES
------------------	----------------	---------------	-----------------------------	--------------	---------------------	---------	----------------------	---------	-----



API 6D STANDARD
600 Class Cast Steel CHECK VALVES PN100
 SWING TYPE, BOLTED COVER

Figure

E430.11



6D-0449

DIMENSIONS (mm) & WEIGHT of E430

DN	ID	ØD	b	Øg	ØK	n	ØI	L	H	Wt	Kv
inch.	mm	mm	mm	mm	mm	no	mm	mm	mm	kg	
2"	49	165	26	92	127	8	19	292	250	24	230
3"	74	210	32	127	168	8	22	356	320	60	530
4"	100	273	38	157	216	8	26	432	375	115	720
6"	150	356	48	216	292	12	29	559	485	242	1790
8"	201	419	56	270	349	12	32	660	510	395	2500
10"	252	508	64	324	432	16	35	787	520	570	4800
12"	303	559	67	381	489	20	35	838	530	716	7500
14"	334	603	70	413	527	20	38	889	580	950	9800
16"	385	686	76	470	603	20	41	991	720	1300	13600
18"	436	743	83	534	654	20	45	1092	800	1960	16200
20"	487	813	89	584	724	24	45	1194	860	2530	22200
24"	589	940	102	692	838	24	51	1397	935	3450	33300
30"	735	1130	114	857	1022	28	54	1651	1050	4500	--
40"	976	1320	159	1111	1213	32	58				--
48"	1166	1595	189	1334	1460	32	73				--

TEST PRESSURE

WORKING PRESSURE

SHELL	153 Bar	-29+38 °C	102 Bar
Closure	113 Bar	+425 °C	58 Bar

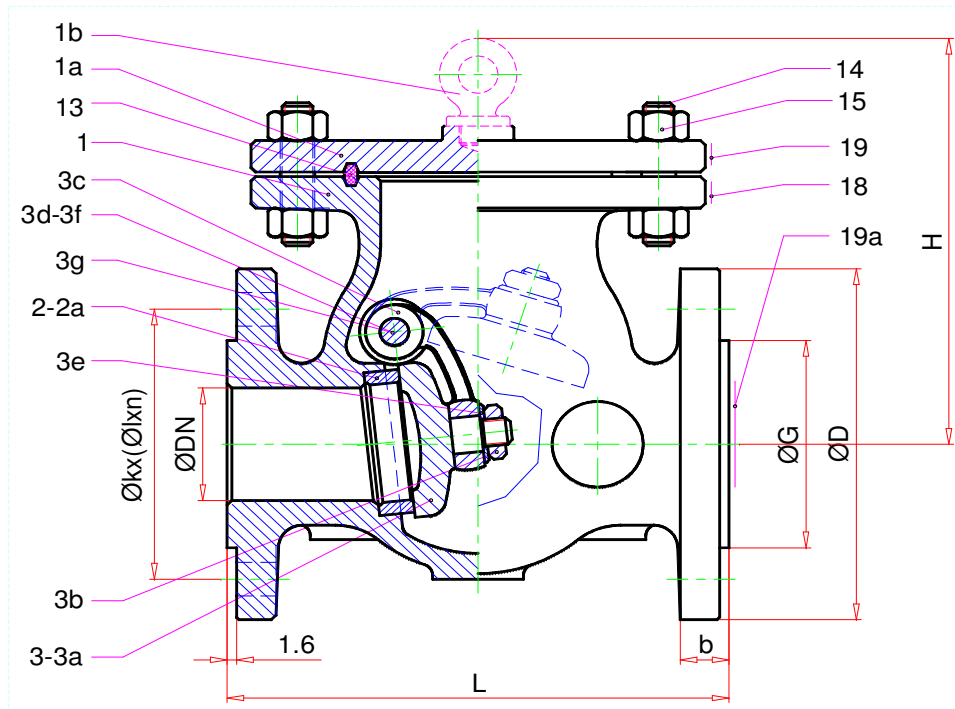

PART LIST for Material No.11

Item	PART NAME	Symb.	material	Item	PART NAME	Symb.	material
1	BODY	WCB	ASTM A216 Gr.WCB	3e	Disc Washer	ST	STEEL
1a	BONNET	ST	ASTM A515	3f	Plug	ST	STEEL
1b	HOOK (*)	ST	ASTM A307.B	3g	Plug Seal	GRF	GRAPHITE
2	BODY SEAT RING	ST	ASTM A105	13	GASKET	RJ	STEEL
2a	Body Seat FACE	Cr13	AWS ER420	14	STUD BOLT	B7	ASTM A193Gr.B7
3	DISC	ST	ASTM A515	15	NUT	2H	ASTM A194Gr.2H
3a	Disc Seat FACE	Cr13	AWS ER420	18	NAME PLATE	SP	STAINLESS PLATE
3b	Disc Nut	2H	ASTM A194Gr.2H	19	PAINT	EP	EPOXY
3c	Disc Hinge	WCB	ASTM A216 Gr WCB	19a	END COVER	PVC	PLASTIC
3d	Disc Pin	Cr13	ASTM A276 T.410				

(*) IF REQUIRED

DESIGN STD:API 6D & BS 1868 & ISO 14313

FACE to FACE STD: ANSI B16.10 & ISO 5752-T5

FLANGE STD.: ANSI B16.5 & ISO 7005-PN110

MAT'L ID :WCB

TRIM ID : Cr13-Cr13-Cr13

Prep.:T. AKYÜREK

Che.:K.KORKMAZ

Appr.:N.Ergin

Rev.No&Date: R5/ 01.04.2009

Description:

Doc No: E430.11-9R0

Attach.

Page&Scale: 1/1 & A4

Origin: DES